

30 Horsebrook, Calne, Wiltshire, SN11 8HG

£900 PCM

- TWO BEDROOM FIRST FLOOR APARTMENT SITUATED JUST OFF THE GREEN IN CALNE
- QUIET RIVERSIDE LOCATION WITHIN CLOSE PROXIMITY OF THE TOWN CENTRE OF CALNE
- LOUNGE/DINING ROOM
- KITCHEN AREA
- TWO BEDROOMS
- BATHROOM
- COMMUNAL GARDEN
- CAR PORT

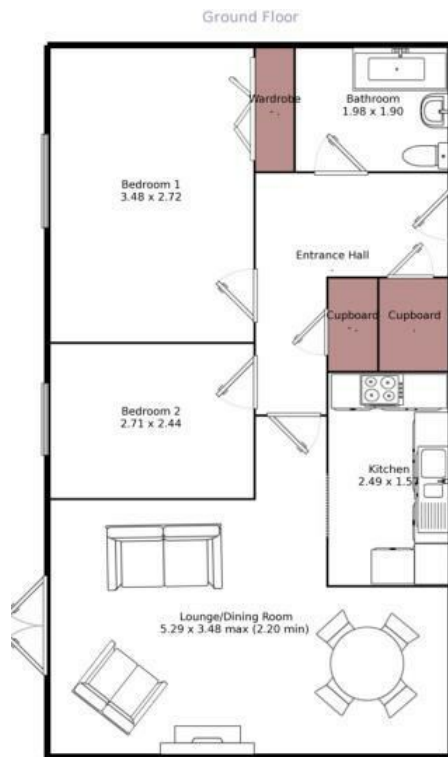

Measurements are approximate. Not to scale. For illustrative purposes only.

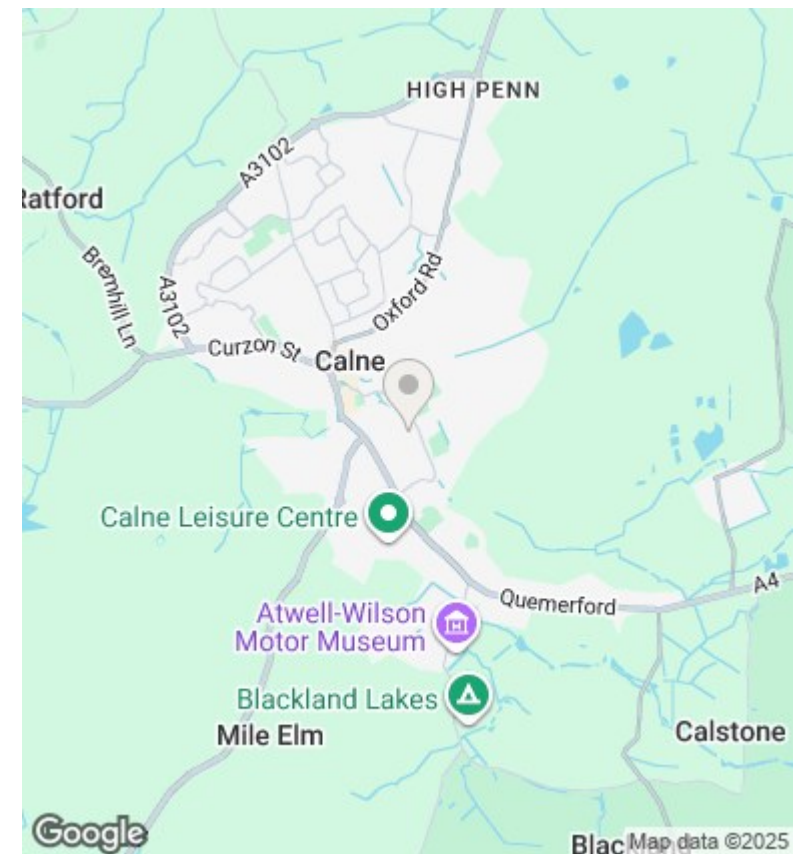

Directions

Viewings

Viewings by arrangement only. Call 01249 466999 to make an appointment.

Council Tax Band

B

EPC Rating:

Energy Efficiency Rating		
	Current	Potential
Very energy efficient - lower running costs		
(92 plus) A		
(81-91) B		
(69-80) C		
(55-68) D		
(39-54) E		
(21-38) F		
(1-20) G		
Not energy efficient - higher running costs		
England & Wales	EU Directive 2002/91/EC	